

 **BOEING**
COMPONENT
MAINTENANCE MANUAL

TO: ALL HOLDERS OF FORWARD ATTENDANTS PANEL ASSEMBLY COMPONENT MAINTENANCE
MANUAL 25-29-53

REVISION NO. 8 DATED MAR 01/02

HIGHLIGHTS

Pages which have been added or revised are outlined below together with the highlights of the revision. Remove and insert the affected pages as listed and enter Revision No. and date on the Record of Revision Sheet.

CHAPTER/SECTION

AND PAGE NO.

103

DESCRIPTION OF CHANGE

Converted foldout graphics to standard size. Graphic content unrevised.

25-29-53

HIGHLIGHTS

01.1

Page 1

Mar 01/02

FORWARD ATTENDANTS PANEL ASSEMBLY

PART NUMBERS 417T6008-42 THRU -49,-51,-52

COMPONENT MAINTENANCE MANUAL
WITH
ILLUSTRATED PARTS LIST

25-29-53

TITLE PAGE

Page 1

Jul 01/92

01.1



REVISION RECORD

- Retain this record in front of manual. On receipt of revision, insert revised pages in the manual, and enter revision number, date inserted and initial.

REVISION NUMBER	REVISION DATE	DATE FILED	BY	REVISION NUMBER	REVISION DATE	DATE FILED	BY



TEMPORARY REVISION AND SERVICE BULLETIN RECORD

BOEING SERVICE BULLETIN	BOEING TEMPORARY REVISION	OTHER DIRECTIVE	DATE OF INCORPORATION INTO MANUAL
		PRR C12027-3 PRR B12140-65	JUL 10/85 JUL 01/92

25-29-53

TR & SB RECORD

01.1

Page 1

Jul 01/92

BOEING
 COMPONENT
 MAINTENANCE MANUAL

PAGE	DATE	CODE	PAGE	DATE	CODE
25-29-53			TESTING & TROUBLE SHOOTING CONT.		
TITLE PAGE			*112	MAR 01/02	01.101
1	JUL 01/92	01.1	*113	MAR 01/02	01.101
2	BLANK		*114	MAR 01/02	01.101
REVISION RECORD			*115	MAR 01/02	01.101
1	JUL 10/85	01	*116	MAR 01/02	01.101
2	BLANK		*117	MAR 01/02	01.101
TR & SB RECORD			*118	MAR 01/02	01.101
1	JUL 01/92	01.1	*119	MAR 01/02	01.101
2	BLANK		120	BLANK	
LIST OF EFFECTIVE PAGES			REPAIR-GENERAL		
*1	MAR 01/02	01	601	JAN 10/87	01.1
THRU LAST PAGE			602	JAN 10/87	01.1
CONTENTS			ILLUSTRATED PARTS LIST		
1	JUL 10/85	01	1001	JUL 10/85	01
2	BLANK		1002	NOV 01/01	01.1
INTRODUCTION			1003	NOV 01/01	01.1
1	APR 10/86	01.1	1004	NOV 01/01	01.1
2	BLANK		1005	NOV 01/01	01.1
DESCRIPTION & OPERATION			1006	NOV 01/01	01.1
1	JUL 10/85	01	1007	NOV 01/01	01.1
2	BLANK		1008	NOV 01/01	01.1
TESTING & TROUBLE SHOOTING			1009	NOV 01/01	01.1
101	JUL 01/92	01.1	1010	NOV 01/01	01.1
102	JUN 01/96	01.1	1011	NOV 01/01	01.1
*103	MAR 01/02	01.1	1012	NOV 01/01	01.1
*104	MAR 01/02	01.101	1013	NOV 01/01	01.1
*105	MAR 01/02	01.101	1014	NOV 01/01	01.1
*106	MAR 01/02	01.101	1015	NOV 01/01	01.1
*107	MAR 01/02	01.101	1016	NOV 01/01	01.1
*108	MAR 01/02	01.101	1017	NOV 01/01	01.1
*109	MAR 01/02	01.101	1018	NOV 01/01	01.1
*110	MAR 01/02	01.101	1019	NOV 01/01	01.1
*111	MAR 01/02	01.101	1020	NOV 01/01	01.1
			1021	NOV 01/01	01.1
			1022	NOV 01/01	01.1
			1023	NOV 01/01	01.1
			1024	BLANK	

* = REVISED, ADDED OR DELETED

25-29-53EFFECTIVE PAGES
LAST PAGE Page 1
01 Mar 01/02

TABLE OF CONTENTS

<u>Paragraph Title</u>	<u>Page</u>
Description and Operation.	1
Testing/Trouble Shooting	101
Disassembly.*[1]	
Cleaning*[1]	
Check.*[1]	
Repair	601
Assembly*[2]	
Fits and Clearances (not applicable)	
Special Tools, Fixtures, and Equipment*[1]	
Illustrated Parts List	1001

*[1] Use applicable procedures in 20-11-04 and standard industry practices.

*[2] Special instructions not required.

25-29-53

01

CONTENTS
 Page 1
 Jul 10/85



INTRODUCTION

The instructions in this manual provide the information necessary to perform maintenance functions including test, fault isolation, and replacement of defective components.

This manual is divided into separate sections:

- | | |
|---|--------------------------------|
| 1. Title Page | 4. List of Effective Pages |
| 2. Record of Revisions | 5. Table of Contents |
| 3. Temporary Revisions &
Service Bulletin Record | 6. Introduction |
| | 7. Procedures and IPL Sections |

Refer to the Table of Contents for the page location of applicable sections. An asterisked flagnote *[] in place of the page number indicates that no special instructions are provided since the function can be performed using standard industry practices.

An explanation of the use of the Illustrated Parts List is provided in the introduction to that section.

All weights and measurements used in the manual are in English units unless otherwise stated. When metric equivalents are given they will be in parentheses following the English units.

Design changes, optional parts, configuration differences and Service Bulletin modifications create alternate part numbers. These are identified in the Illustrated Parts List (IPL) by adding an alphabetical character to the basic item number. The resulting item number is called an alpha-variant. Throughout the manual, IPL basic item number references also apply to alpha-variants unless otherwise indicated.

Verification:

| Testing/TS Nov 11, 1982

25-29-53

INTRODUCTION

01.1

Page 1

Apr 10/86



FORWARD ATTENDANTS PANEL ASSEMBLY

DESCRIPTION AND OPERATION

1. The forward attendants panel assembly consists of switches and indicators mounted on a plastic shell. A wire bundle interconnects the various components and provides two connectors for interfacing with airplane wiring.

25-29-53

DESCRIPTION & OPERATION

01

Page 1

Jul 10/85

TESTING AND TROUBLE SHOOTING1. Test Equipment

- A. Power Supplies: 28v dc, 2 ampere
115V AC, 400 Hz, 0.5 ampere current limit
0 to -15v dc, variable
- B. Multimeter: Simpson 260, or equivalent
Fluke 8050A, or equivalent
- C. Test Connectors: BACC45FN24-61S (mates with P1) and BACC45FN16-24S
(mates with P2). (Boeing Breakout Box A33003-2 with Cables A33003-65,
A33003-30 and A33003-193 may be used.)

2. Functional Test

- A. Identify part to be tested. Refer to chart below for part dash number applicability. This will determine the figure and sheets to use for the functional test. Figure 102 and 103 are for the functional test, Fig. 104 is the schematics.
- B. For component identification and location, refer to Fig. 101.

NOTE: Some circuits are identical except that switch reference designators may differ. When reference designators differ between identical circuits, the least common reference designator is enclosed in parentheses in text and in figures thus: S7 (S8).

- C. Perform functional test as indicated in Fig. 102 and 103. Apply voltage as required for the step, perform the step and remove voltage. Refer to Component Tested column for suspect component(s) should the step fail.
- (1) For test purposes, CON means continuity - 3 ohms or less, OPEN means open circuit - 15k or more.

25-29-53

3. Test Figure Applicability Chart

FIG.	SH	417T6008 PANEL ASSEMBLY															
		ALL	-42	-43	-44	-45	-46	-47	-48	-49	-51	-52					
101	1	X															
102	1	X															X
102	2	X															X
102	3		X	X		X					X						X
102	4				X		X										
102	5								X								
102	6								X								
103		X															X
104		X															
105			X	X	X	X											
106		X															
107								X									
108	1		X	X		X		X		X	X	X					
108	2	X															X
108	3		X	X	X		X	X		X							
108	4				X		X										
108	5		X	X		X		X		X	X	X					
108	6								X								
108	7								X		X	X					

 Test Figure Applicability Chart
 Figure 100

25-29-53

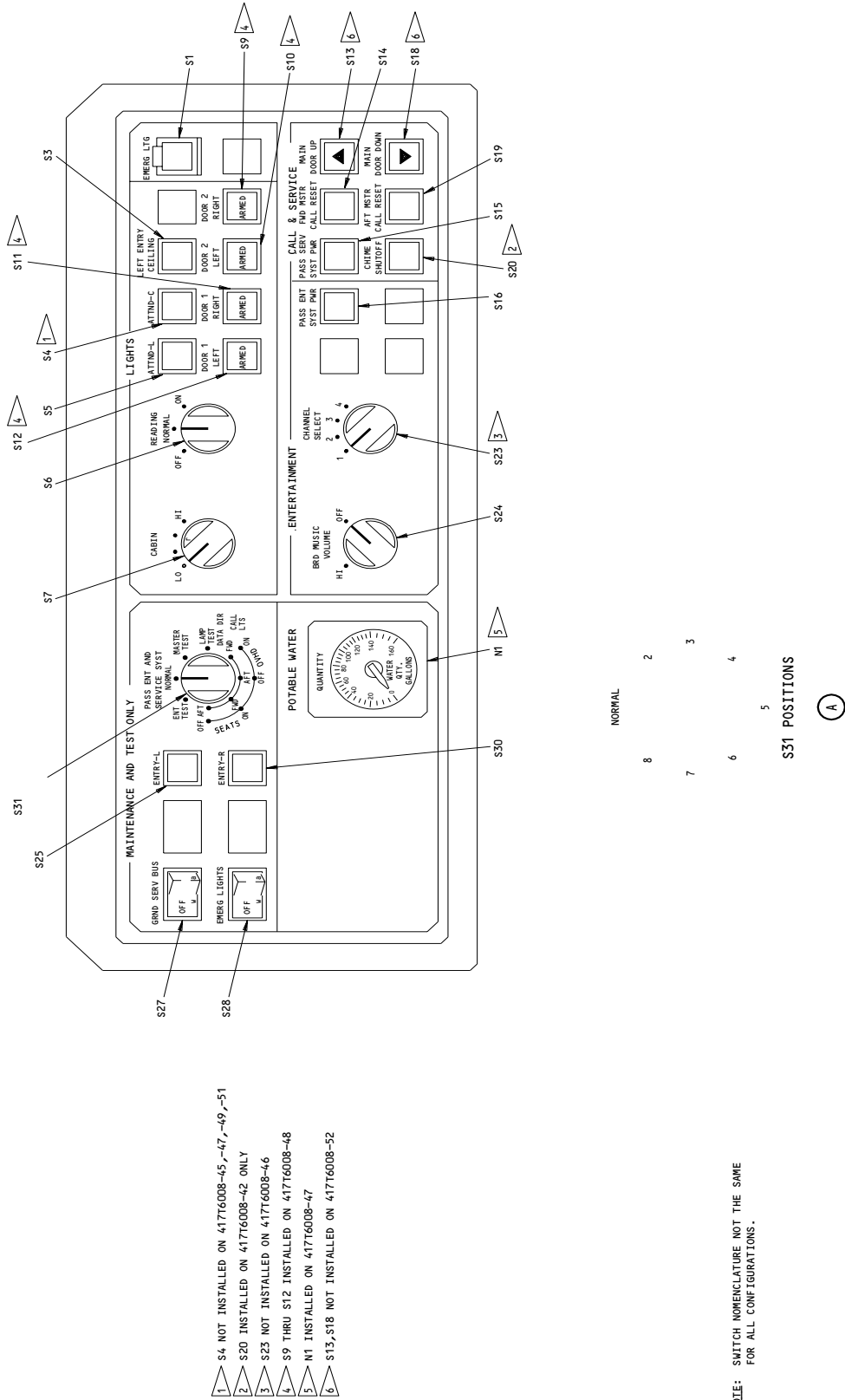

- 1 S4 NOT INSTALLED ON 417T6008-45,-47,-49,-51
- 2 S20 INSTALLED ON 417T6008-42 ONLY
- 3 S23 NOT INSTALLED ON 417T6008-46
- 4 S9 THRU S12 INSTALLED ON 417T6008-48
- 5 M1 INSTALLED ON 417T6008-47
- 6 S13, S18 NOT INSTALLED ON 417T6008-52

NOTE: SWITCH NOMENCLATURE NOT THE SAME FOR ALL CONFIGURATIONS.

417T6008-42 THRU -49,-51,-52
 Component Identification
 Figure 101

25-29-53

APPLY 28V DC + -	SWITCH OPERATION	CON BETWEEN	OPEN BETWEEN	INDICATOR(S)	COMPONENT TESTED
	<u>FOR 417T6008-42 THRU -49,-51 ONLY</u>				
<u>P1 PINS</u>		<u>P1 PINS</u>			
24 22	PRESS AND HOLD S18			S18 ON	S18
24 22	RELEASE S18			S18 OFF	
		23 & 25			
		48 & 24	23 & 24		
	PRESS S18 MOMENTARILY	23 & 24	48 & 24		
49 22	PRESS AND HOLD S13			S13 ON	S13
49 22	RELEASE S13			S13 OFF	
		26 & 27			
		28 & 49			
	PRESS S13 MOMENTARILY	27 & 49	27 & 49		
	<u>ALL</u>				
19 20			17 & 18	S27 ON	S27
	PRESS S27 MOMENTARILY	17 & 18			
43 44	PRESS S1 SEVERAL TIMES AND LEAVE ON			S1 OFF/ON ALTERNATELY	S1
	S1 ON	44 & 45	33 & 45		S1
	PRESS S1 (TO OFF)	33 & 44	44 & 45		S1

417T6008-42 THRU -49,-51,-52

 Functional Test
 Figure 102 (Sheet 1)

25-29-53

 TESTING & TROUBLE SHOOTING
 01.101 Page 104
 Mar 01/02

BOEING
 COMPONENT
 MAINTENANCE MANUAL

APPLY 28V DC + -	SWITCH OPERATION	CON BETWEEN	OPEN BETWEEN	INDICATOR(S)	COMPONENT TESTED
<u>P2 PINS</u>			<u>P2 PINS</u>		
13 20 11 20	PRESS S16 SEVERAL TIMES			S16 ON S16 ALTERNATELY ON/OFF	S16
14 20 11 20	PRESS S15 SEVERAL TIMES			S15 ON S15 ALTERNATELY ON/OFF	S15
11 20	<u>FOR 417T6008-42 ONLY</u> PRESS S20 SEVERAL TIMES			S20 ALTERNATELY ON/OFF	S20
	PRESS S20 ON		10 & 9		
	PRESS S20 OFF	10 & 9			
	<u>ALL</u>				
11 21 11 23	SET OR HOLD S6 TO OFF, PRESS S14 RELEASE S14 RELEASE S6 OR SET S6 TO NORMAL PRESS S14 RELEASE S14 PRESS S19 RELEASE S19 PRESS S14 RELEASE S14	18 & 22	18 & 22	S14 ON S19 ON	S14 S19 S6,S14
	PRESS S19 RELEASE S19	15 & 22 15 & 22	15 & 22		S14,S19 S19
	PRESS S19 RELEASE S19	15 & 22 21 & 20	21 & 20		S19
	S6 ON, PRESS S19 AND HOLD RELEASE S19	16 & 22 23 & 20	23 & 20		S19
	S6 ON, S31 TO 1 (NORMAL) S31 TO 2 THRU 8 (CW FROM 1) S31 TO 8 S31 TO 2 S31 TO 2 S31 TO 5 S31 TO 2	15 & 19	15 & 19		S6,S19
	S31 TO 3	19 & 20 17 & 20 11 & 12 11 & 12 15 & 20 19 & 20 24 & 20	18 & 20		S6,S31 S31

417T6008-42 THRU -49,-51,-52

 Functional Test
 Figure 102 (Sheet 2)

25-29-53

 TESTING & TROUBLE SHOOTING
 01.101 Page 105
 Mar 01/02

APPLY 28V DC + -	SWITCH OPERATION	CON BETWEEN	OPEN BETWEEN	INDICATOR(S)	COMPONENT TESTED
<u>P1 PINS</u>		<u>P1 PINS</u>			
34 36 34 35	RELAY K1 ENERGIZED RELAY K2 ENERGIZED				
	<u>NOTE:</u> MAINTAIN K1, K2 ENERGIZED STATE UNTIL DIRECTED OTHERWISE				
21 11 14 11 12 11 15 11				S3 ON S30 ON S25 ON S5 ON	S3 S30,K1 S25,K2 S5
16 11	<u>FOR 417T6008-42,-43</u>			S4 ON	S4
	<u>ALL</u>				
13 11 13 11 13 11	PRESS AND HOLD S28 RELEASE S28	37 & 38		S28 OFF S28 ON S28 OFF	S28
	PRESS S25 TO ON	12 & 13	37 & 38		S25,K2
	PRESS S25 TO OFF		12 & 13		
	PRESS S25 TO ON		12 & 13		K2
	DE-ENERGIZE K2				
	PRESS S25 TO OFF				
	PRESS S30 TO ON	13 & 14			S30,K1
	PRESS S30 TO OFF		13 & 14		
	PRESS S30 TO ON				
	DE-ENERGIZE K1		14 & 13		K1
	PRESS S30 TO OFF				
	PRESS S5 TO ON	13 & 15			S5
	PRESS S5 TO OFF		13 & 15		
	PRESS S3 TO ON	13 & 21			S3
	PRESS S3 TO OFF		13 & 21		
	<u>FOR 417T6008-42,-43</u>				
	PRESS S4 TO ON	13 & 16			S4
	PRESS S4 TO OFF		13 & 16		

417T6008-42,-43,-45,-47,-49,-51,-52

 Functional Test
 Figure 102 (Sheet 3)

25-29-53

 TESTING & TROUBLE SHOOTING
 01.101 Page 106
 Mar 01/02

BOEING
 COMPONENT
 MAINTENANCE MANUAL

APPLY 28V DC + -		SWITCH OPERATION	CON BETWEEN	OPEN BETWEEN	INDICATOR(S)	COMPONENT TESTED	
<u>P1 PINS</u>			<u>P1 PINS</u>				
		SET S7 TO 4 (FULL CW)	2 & 9 6 & 9 7 & 10 3 & 1 4 & 1			K4 S7,K4 S7,K4 S7,K3 S7,K3	
		SET S7 TO 3 (CCW FROM 4)	6 & 9 3 & 1			K4,S7 K3,S7	
34	36	APPLY 115V AC BETWEEN P1-1 (HIGH) AND P1-40	9 & 10 7 & 10		K1 ENERGIZED K2 ENERGIZED K3,K4 ENERGIZED	K4 K4	
34	35						
		<u>NOTE:</u> MAINTAIN K1-K4 ENERGIZED STATE UNTIL DIRECTED OTHERWISE					
		K3,K4 DE-ENERGIZED			VERIFY 115V AC BETWEEN P1-3,P1-40 P1-4,P1-40	K3 K3	
21	11	PRESS AND HOLD S28 RELEASE S28 PRESS S25 TO ON PRESS S25 TO OFF PRESS S25 TO ON DE-ENERGIZE K2 PRESS S25 TO OFF PRESS S30 TO ON PRESS S30 TO OFF PRESS S30 TO ON DE-ENERGIZE K1 PRESS S30 OFF PRESS S5 TO ON PRESS S5 TO OFF PRESS S4 TO ON PRESS S4 TO OFF PRESS S3 TO ON PRESS S3 TO OFF	37 & 38		S3 ON S4 ON S5 ON S25 ON S30 ON S28 OFF S28 ON S28 OFF	S3 S4 S5 S25,K2 S30,K1 S28	
16	11		12 & 13	37 & 38			S25
15	11				12 & 13		
12	11				12 & 13		K2
14	11		13 & 14		13 & 14		S30
13	11				14 & 13		K1
13	11		13 & 15		13 & 15		S5
13	11		13 & 16		13 & 16		S4
			13 & 21		13 & 21		S3

417T6008-44,-46

 Functional Test
 Figure 102 (Sheet 4)

25-29-53

 TESTING & TROUBLE SHOOTING
 01.101 Page 107
 Mar 01/02

APPLY 28V DC + -	SWITCH OPERATION	CON BETWEEN	OPEN BETWEEN	INDICATOR(S)	COMPONENT TESTED
<u>P1 PINS</u>		<u>P1 PINS</u>			
	SET S7 TO 4 (FULL CW)	3 & 1 4 & 1 2 & 9 6 & 9 7 & 10			K3,S7 K3,S7 K4, S7 K4, S7 K4, S7
	SET S7 TO 3	3 & 1 6 & 9			S7 S7
	APPLY 115V AC TO PINS P1-1 (HIGH) AND P1-40	7 & 10 9 & 10		K3,K4 ENERGIZED 115V AC BETWEEN P1-3,P1-40 P1-4,P1-40 P1-41,P1-40	K4 K4 K3 K3 K1,K2
	<u>NOTE:</u> MAINTAIN K3,K4 ENERGIZED UNTIL DIRECTED OTHERWISE.				
34 36				K1 ENERGIZED	
	<u>NOTE:</u> MAINTAIN K1 ENERGIZED UNTIL DIRECTED OTHERWISE				
				115V AC BETWEEN P1-42,P1-40	K1
34 35				K2 ENERGIZED	
	<u>NOTE:</u> MAINTAIN K2 ENERGIZED UNTIL DIRECTED OTHERWISE				
	DE-ENERGIZE K3,K4			115V AC BETWEEN P1-42,P1-40	K2
14 11 12 11				S30 ON S25 ON	K1,S30 K2,S25 S30
	PRESS S30 TO ON PRESS S30 TO OFF PRESS S25 TO ON PRESS S25 TO OFF	13 & 14 13 & 12	13 & 14 13 & 12		S25
	DE-ENERGIZE K1 PRESS S30 TO ON PRESS S30 TO OFF		13 & 14		K1
	DE-ENERGIZE K2 PRESS S25 TO ON PRESS S25 TO OFF		13 & 12		K2

417T6008-48

 Functional Test
 Figure 102 (Sheet 5)

25-29-53

 TESTING & TROUBLE SHOOTING
 01.101 Page 108
 Mar 01/02

BOEING
 COMPONENT
 MAINTENANCE MANUAL

APPLY 28V DC + -	SWITCH OPERATION	CON	OPEN	INDICATOR(S)	COMPONENT TESTED
		BETWEEN	BETWEEN		
<u>P1 PINS</u>		<u>P1 PINS</u>			
21 11				S3 ON	S3
16 11				S4 ON	S4
15 11				S5 ON	S5
13 11				S28 OFF	S28
13 11	PRESS AND HOLD S28	37 & 38		S28 ON	
13 11	RELEASE S28		37 & 38	S28 OFF	
	PRESS S3 TO ON	13 & 21			S3
	PRESS S3 TO OFF		13 & 21		
	PRESS S4 TO ON	13 & 16			S4
	PRESS S4 TO OFF		13 & 16		
	PRESS S5 TO ON	13 & 15			S5
	PRESS S5 TO OFF		13 & 15		
29 30	PRESS AND HOLD S9			S9 ON	S9
29 30	RELEASE S9			S9 OFF	
29 30	PRESS AND HOLD S10			S10 ON	S10
29 30	RELEASE S10			S10 OFF	
29 30	PRESS AND HOLD S11			S11 ON	S11
29 30	RELEASE S11			S11 OFF	
29 30	PRESS AND HOLD S12			S12 ON	S12
29 30	RELEASE S12			S12 OFF	
29 56	PRESS AND HOLD S9			S9 OFF	S9
29 56	RELEASE S9			S9 ON	
29 47	PRESS AND HOLD S10			S10 OFF	S10
29 47	RELEASE S10			S10 ON	
29 46	PRESS AND HOLD S11			S11 OFF	S11
29 46	RELEASE S11			S11 ON	
29 39	PRESS AND HOLD S12			S12 OFF	S12
29 39	RELEASE S12			S12 ON	

417T6008-48

 Functional Test
 Figure 102 (Sheet 6)

25-29-53

 TESTING & TROUBLE SHOOTING
 01.101 Page 109
 Mar 01/02

BETWEEN P1 PIN	POSITION			
	1 (FULLY CCW)	2 (CW FROM 1)	3 (CW FROM 2)	4 (FULLY CW)
1 AND 8	CON	CON	OPEN	OPEN
6 AND 2	OPEN	CON	CON	CON
31 AND 32	CON	OPEN	OPEN	OPEN

417T6008-44,-46,-48

BETWEEN P1 PIN	POSITION			
	1 (FULLY CCW)	2 (CW FROM 1)	3 (CW FROM 2)	4 (FULLY CW)
1 AND 8	CON	CON	OPEN	OPEN
1 AND 4	OPEN	OPEN	OPEN	CON
1 AND 3	OPEN	OPEN	CON	CON
32 AND 31	CON	OPEN	OPEN	OPEN
10 AND 7	OPEN	OPEN	OPEN	CON
6 AND 9	OPEN	OPEN	CON	CON
6 AND 2	OPEN	CON	CON	CON

 417T6008-42,-43,-45,-47,-49,-51,-52
 Switch S7 Test
 Figure 103

MULTIMETER CONNECTION		OPERATION	RESULTS	COMPONENT TESTED
+	-			
P2-4	P2-5	S24 (S34) ROTATED CW FROM OFF	CONTINUITY	SWITCH
P2-4	P2-5	S24 (S34) ROTATED CCW TO OFF	OPEN	
P2-2	P2-3	S24 (S34) ROTATED SLOWLY CW	RESISTANCE INCREASES (10K NOM)	POT
P2-1	P2-3	S24 (S34) ROTATED SLOWLY CCW	RESISTANCE INCREASES (10K NOM)	
P2-1	P2-2	NONE	9 TO 11 KILOHMS	

 Switch S24 Test
 Figure 104

25-29-53

 TESTING & TROUBLE SHOOTING
 01.101 Page 110
 Mar 01/02

BOEING
 COMPONENT
 MAINTENANCE MANUAL

MULTIMETER CONNECTION		POSITION	RESULTS
+	-		
P2-8	P2-6	1	OPEN
P2-8	P2-7	1	OPEN
P2-8	P2-6	2	CON
P2-8	P2-7	2	OPEN
P2-8	P2-6	3	OPEN
P2-8	P2-7	3	CON
P2-8	P2-6	4	CON
P2-8	P2-7	4	CON

1 S23 NOT INSTALLED ON 417T6008-46

Switch S23 Continuity Test 1
 Figure 105

S31 (S15) POSITION	MEASURE BETWEEN	DIODE TESTED	50 OHMS MAX WITH + AT	100 KOHMS MIN WITH + AT
6	P2-24, P2-20	CR2	P2-24	P2-20
4	P2-24, P2-20	CR1	P2-24	P2-20
4	P2-18, P2-20	CR3	P2-18	P2-20
7	P2-18, P2-20	CR4	P2-18	P2-20
8	P2-19, P2-20	CR5	P2-19	P2-20
7	P2-19, P2-20	CR8	P2-19	P2-20
6	P2-19, P2-20	CR7	P2-19	P2-20
-	CR5-C, CR1-C	CR6	CR5-C	CR1-C

NOTE: WHEN VIEWING TB-1 FROM REAR OF PANEL, DIODES NUMBERED CR8 TO CR1, LEFT TO RIGHT.

Diode Test
 Figure 106

25-29-53

TESTING & TROUBLE SHOOTING
 01.101 Page 111
 Mar 01/02

COMPONENT TESTED	PROCEDURE	REQUIRED RESULTS
N1	Apply 0V DC between P2 pins 30(-) and 29(+) Adjust voltage to have gage measure exactly 0 GAL Adjust voltage to have gage measure exactly: 20 GAL 40 GAL 60 GAL 80 GAL 100 GAL 120 GAL 140 GAL 160 GAL	Voltage measures -0.20 to 0.0V DC -1.87 to -1.47V DC -3.26 to -2.86V DC -4.43 to -4.03V DC -5.48 to -5.08V DC -6.53 to -6.13V DC -7.53 to -7.13V DC -8.58 to -8.18V DC -10.20 to -9.80V DC

417T6008-47

 Gage Test
 Figure 107

25-29-53

 TESTING & TROUBLE SHOOTING
 01.101 Page 112
 Mar 01/02

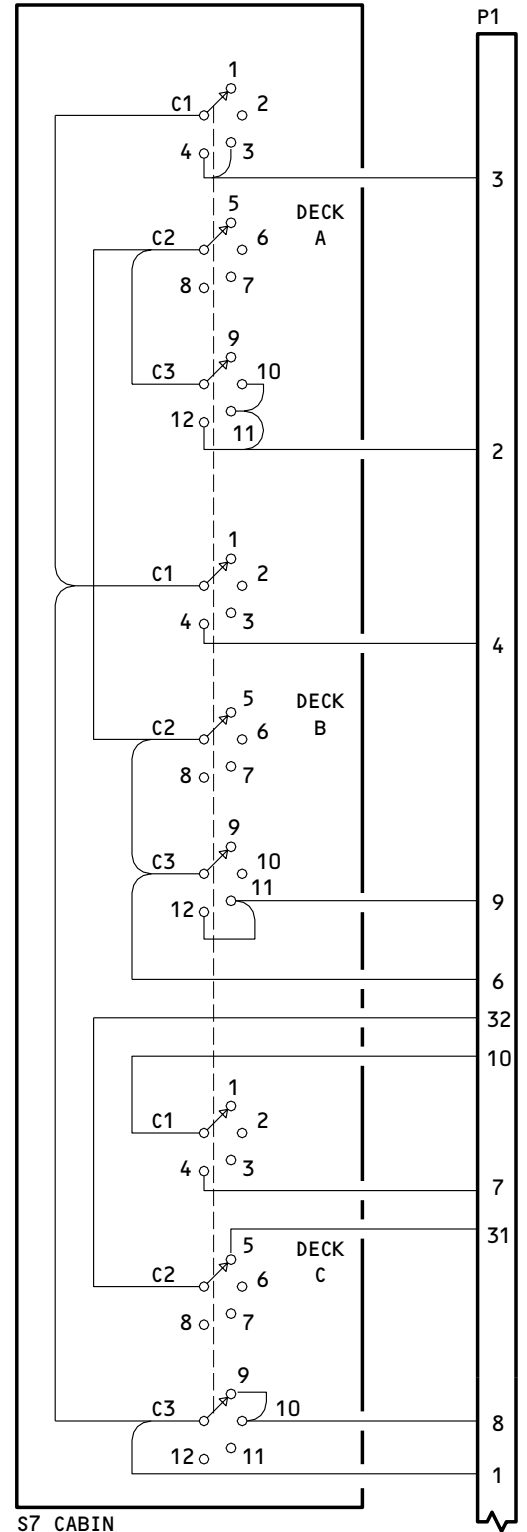

NOTE: ALL WIRES ARE BMS 13-48, AWG 22.

417T6008-42,-43,-45,-47,-49,-51,-52

Schematic Diagram
 Figure 108 (Sheet 1)

25-29-53

TESTING & TROUBLE SHOOTING
 01.101 Page 113
 Mar 01/02

COMPONENT
MAINTENANCE MANUAL

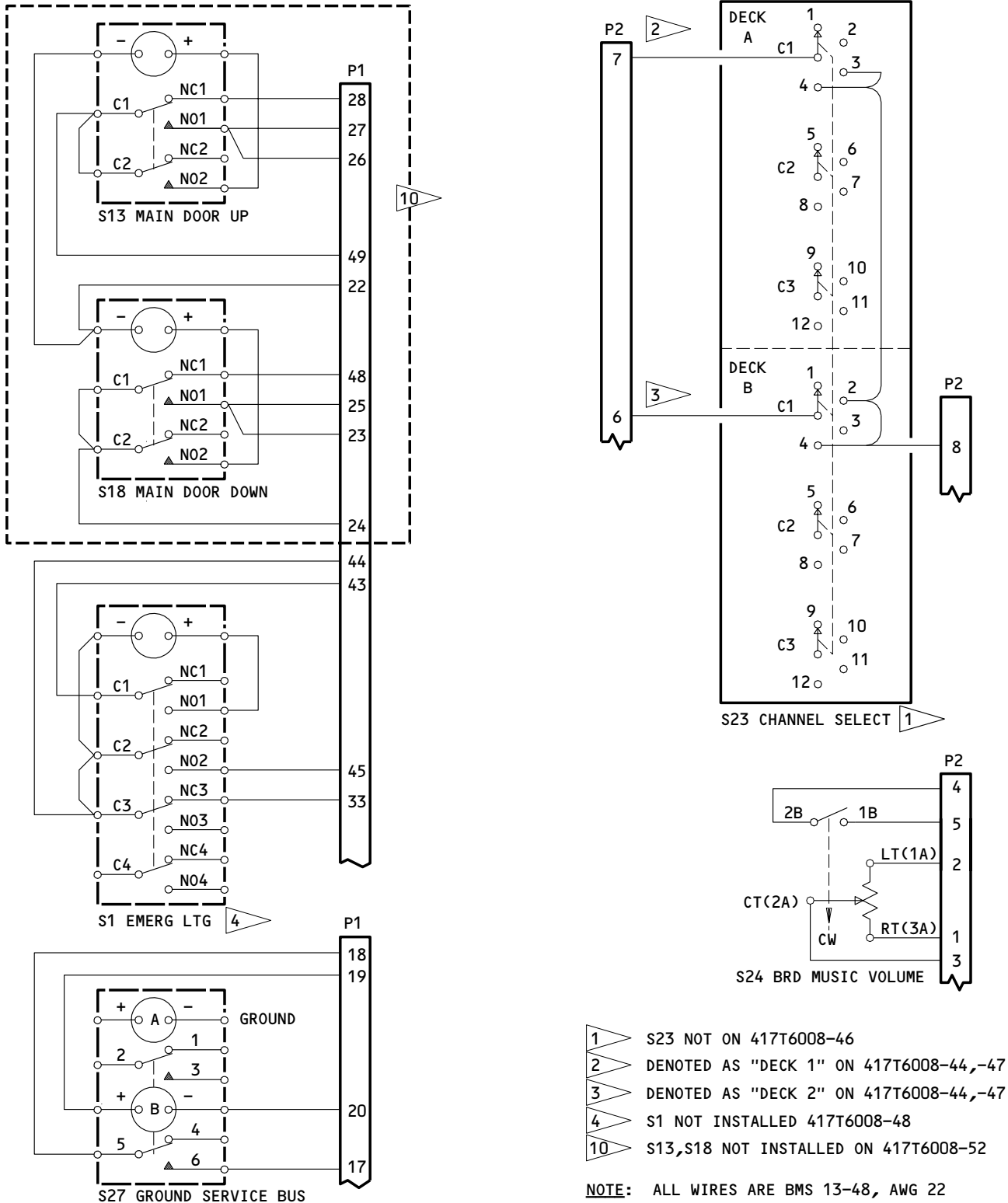

- 1 S23 NOT ON 417T6008-46
- 2 DENOTED AS "DECK 1" ON 417T6008-44,-47
- 3 DENOTED AS "DECK 2" ON 417T6008-44,-47
- 4 S1 NOT INSTALLED 417T6008-48
- 10 S13,S18 NOT INSTALLED ON 417T6008-52

NOTE: ALL WIRES ARE BMS 13-48, AWG 22

417T6008-42 THRU -49,-51,-52

Schematic Diagram
Figure 108 (Sheet 2)

25-29-53

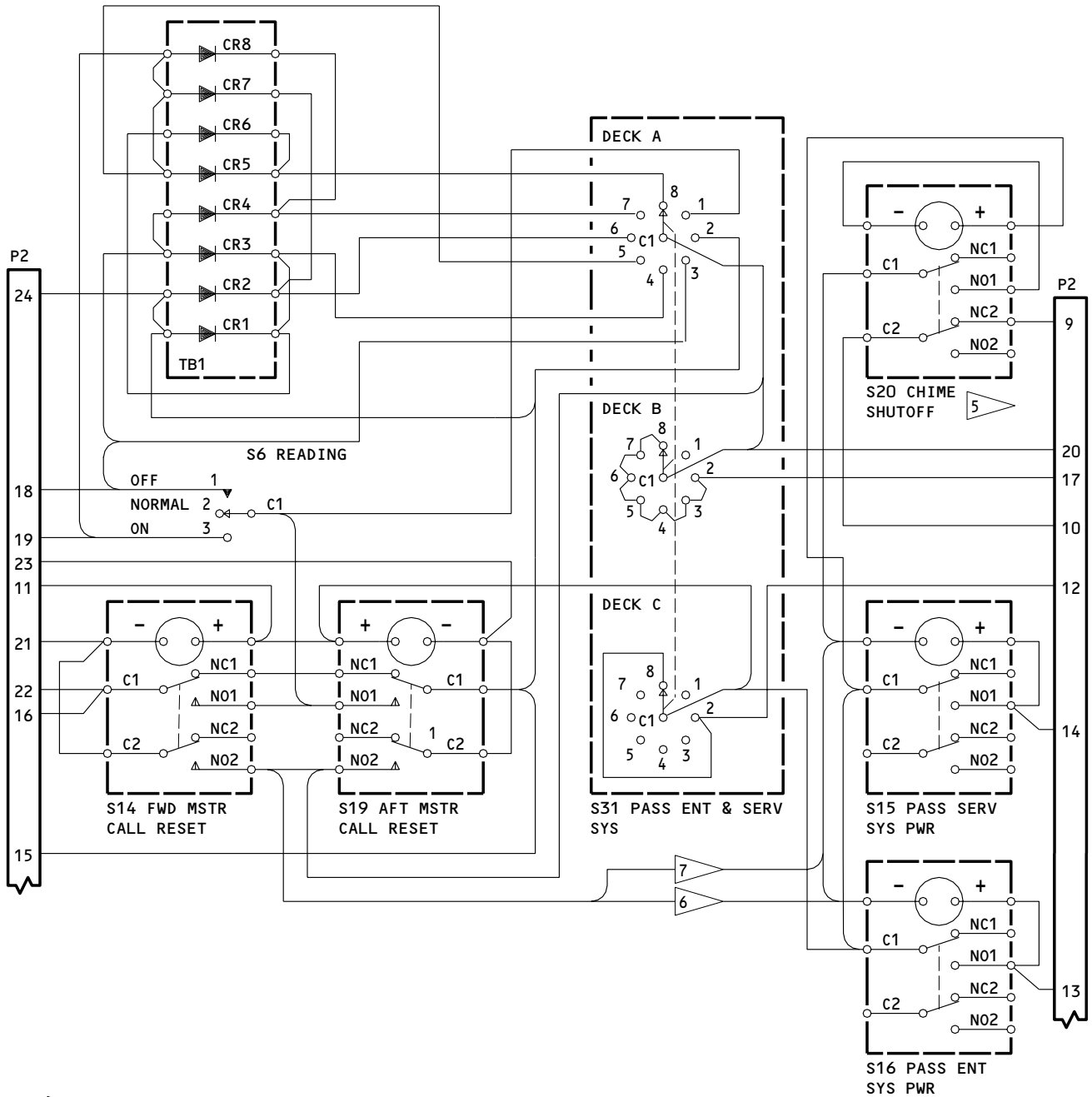

- 5 S20 INSTALLED ON 417T6008-42 ONLY
- 6 417T6008-42,-43,-44,-46
- 7 417T6008-45,-47,-49

NOTE: ALL WIRES ARE BMS 13-48, AWG 22.

417T6008-42 THRU -47,-49

Schematic Diagram
 Figure 108 (Sheet 3)

25-29-53

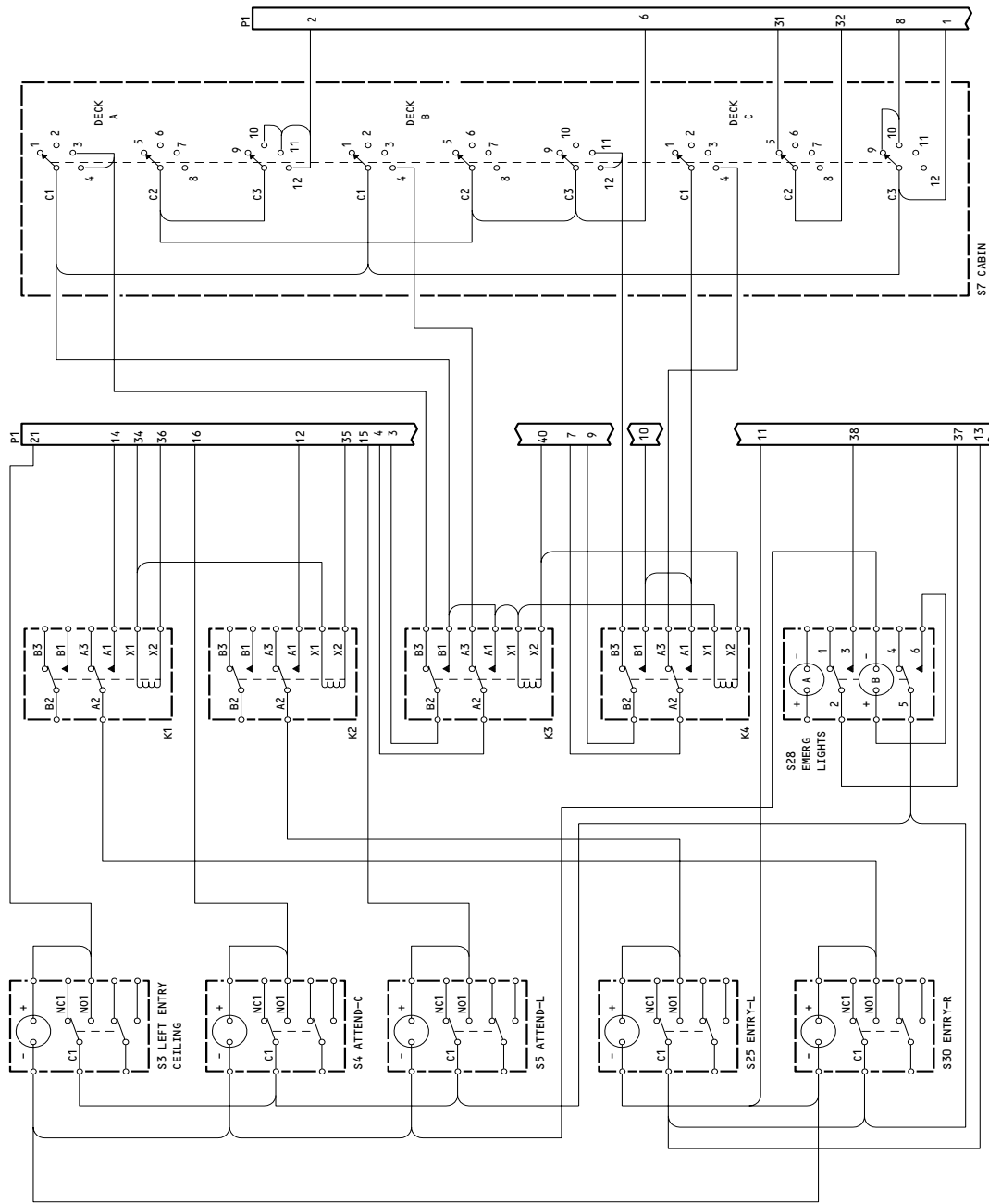

NOTE: ALL WIRES ARE
 BMS 13-48, ANG 22

417T6008-4,-46

Schematic Diagram
 Figure 108 (Sheet 4)

25-29-53

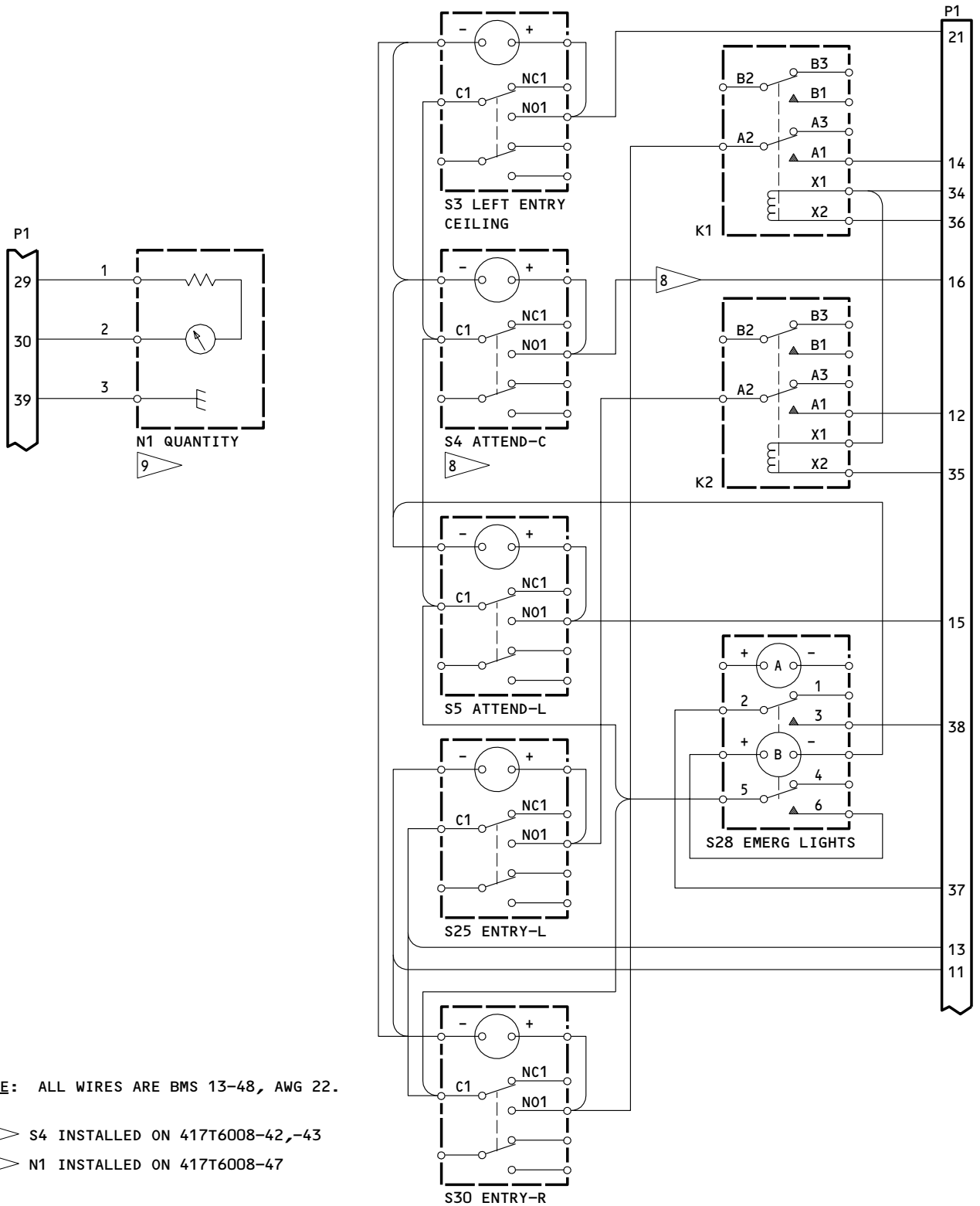

NOTE: ALL WIRES ARE BMS 13-48, AWG 22.

8 S4 INSTALLED ON 417T6008-42,-43

9 N1 INSTALLED ON 417T6008-47

417T6008-42,-43,-45,-47,-49,-51,-52

Schematic Diagram
 Figure 108 (Sheet 5)

25-29-53

TESTING & TROUBLE SHOOTING
 01.101 Page 117
 Mar 01/02

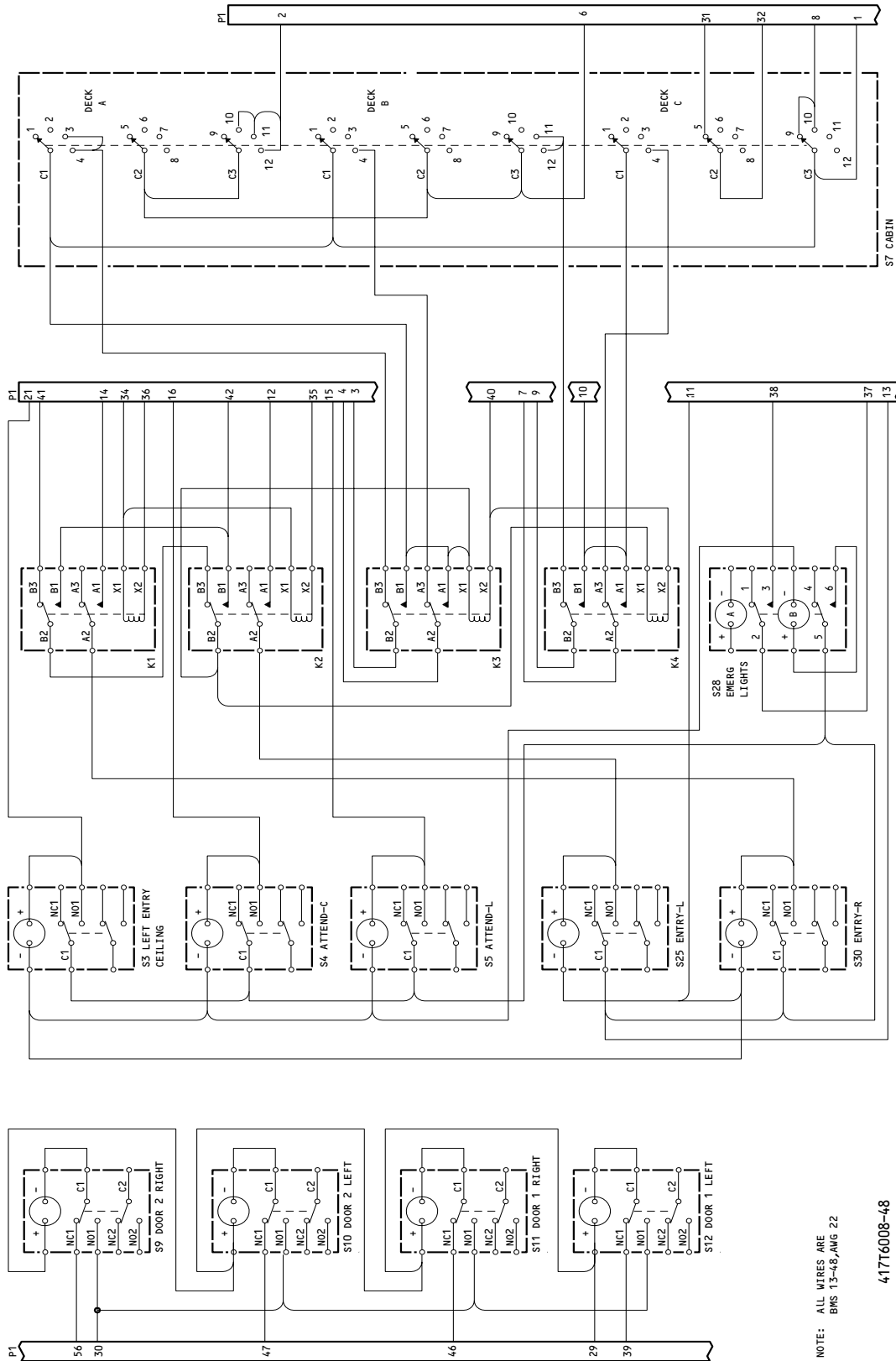

Schematic Diagram
 Figure 108 (Sheet 6)

NOTE: ALL WIRES ARE
 BMS 13-48, ANG 22

417T6008-48

25-29-53

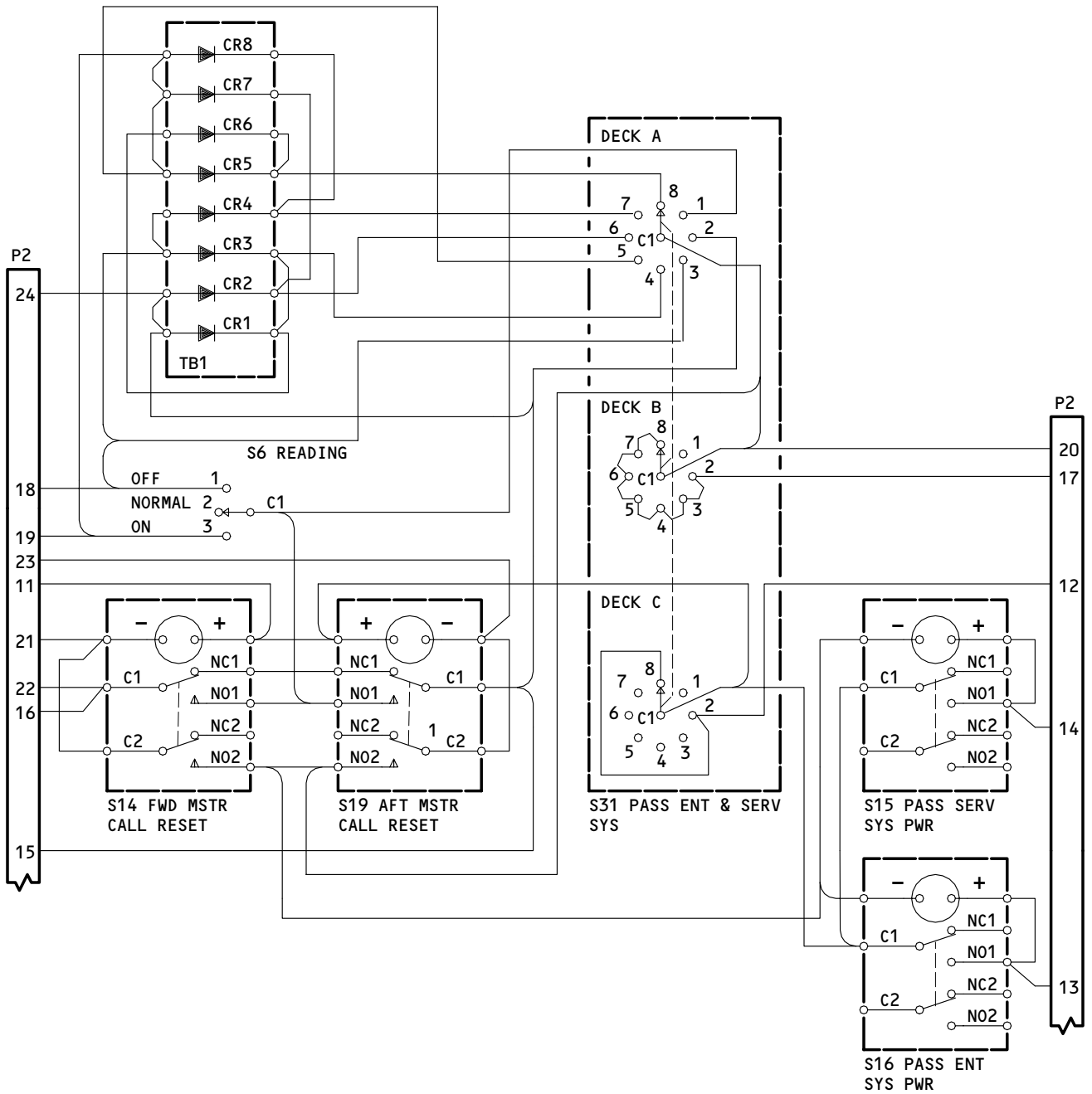

NOTE: ALL WIRES ARE BMS 13-48, AWG 22.

417T6008-48,-51,-52

Schematic Diagram
 Figure 108 (Sheet 7)

25-29-53

REPAIR1. Materials

- A. Glyptol No. 1201 (General Electric Co., Insulating Materials Product Section, 1 Campbell Road, Schenectady, New York 12306)
- B. Xylene (also known as Xylol)
- C. Solvent: Aliphatic naphtha, denatured alcohol, or isopropyl alcohol
- D. Adhesive: Scotch-Grip Insulation Adhesive 37 (3M Company, 3M Center, St. Paul, Minnesota 55101)
- E. Abrasive: Aluminum oxide paper, 180 grit or finer
- F. Lint free wipers

2. Repair can be accomplished using applicable procedures in 20-11-04 and standard industry practices except as noted in following.

- A. Bond relay bracket (IPL Fig. 1-148) to rear of faceplate assembly with adhesive type 82 per 20-50-12.
- B. Replace diode module (CR1, CR2, CR3, CR4, CR5, CR6, CR7, CR8) as follows:
 - (1) Loosen screw of clamp (IPL Fig. 1-150) nearest to faulty diode module. Remove clamp.
 - (2) Remove faulty diode and orient replacement diode so that the polarity markings (A and C) are in the same relative positions as on adjacent diodes.
 - (3) Replace clamp and tighten holding screw.
- C. Replace wires with BMS 13-48, type 1, class 1, AWG 22, except as follows:
 - (1) Wires between terminals of the same switch are QQ-W-343, type S tinned bus wire with insulating sleeving per MIL-I-22129 or BMS 13-48, type 1, class 1.

25-29-53

REPAIR-GENERAL

01.1

Page 601

Jan 10/87

- D. Install rotary switches by applying Glyptol No. 1201 to threaded areas per manufacturer's instructions.

NOTE: Switches have been installed with Glyptol No. 1201 and may be difficult to remove. Glyptol can be softened by daubing coated threads with a swab that has been immersed in xylene.

- (1) When installing knob (IPL item 1-65) on switch S31, verify that flat of switch shaft is aligned with terminal 5 of switch and that arrow on knob points to NORMAL.

- E. Before replacing switch S28 (IPL Fig. 1-45) or switch S19 (IPL Fig. 1-105), bond raised bezel (IPL Fig. 1-17, Fig. 1-50) to front of new switch as follows:

- (1) Clean faying surface on front of switch and on bezel as follows:

- (a) Wipe with solvent.
- (b) Remove gloss with abrasive.
- (c) Wipe with clean wiper.
- (d) Repeat solvent wipe.
- (e) Let solvent evaporate.

CAUTION: DO NOT ALLOW ANY ADHESIVE TO ENTER THE SWITCH MECHANISM.

- (2) Apply adhesive to each faying surface per manufacturer's instructions and allow it to dry until tacky (not longer than 1 hour). Mate faying surfaces and maintain contact pressure for at least 1 hour before handling. Avoid side and/or tension forces for 24 hours.

- F. Replace raised bezel on switch S28 or S19 as follows:

- (1) Push switch out 0.20 inch maximum.
- (2) Remove old bezel and adhesive.
- (3) Repeat E.(1) and E.(2).
- (4) Push switch back in.

25-29-53

REPAIR-GENERAL

01.1

Page 602

Jan 10/87



ILLUSTRATED PARTS LIST

1. This section lists and illustrates replaceable or repairable component parts. The Illustrated Parts Catalog contains a complete explanation of the Boeing part numbering system.
2. Indentures show parts relationships as follows:

Assembly

Detail Parts for Assembly

Subassembly

Attaching Parts for Subassembly

Detail Parts for Subassembly

Detail Installation Parts (Included only if installation parts may be returned to shop as part of assembly)

3. One use code letter (A, B, C, etc.) is assigned in the EFF CODE column for each variation of top assembly. All listed parts are used on all top assemblies except when limitations are shown by use code letter opposite individual part entries.
4. Letter suffixes (alpha-variants) are added to item numbers for optional parts, Service Bulletin modification parts, configuration differences (except left- and right-hand parts), product improvement parts, and parts added between two sequential item numbers. The alpha-variant is not shown on illustrations when appearance and location of all variants of the part are the same.
5. Service Bulletin modifications are shown by the notations PRE SB XXXX and POST SB XXXX.
 - A. When a new top assembly part number is assigned by Service Bulletin, the notations appear at the top assembly level only. The configuration differences at detail part level are then shown by use code letter.
 - B. When the top assembly part number is not changed by the Service Bulletin, the notations appear at the detail part level.

6. Parts Interchangeability

Optional
(OPT)

The parts are optional to and interchangeable with other parts having the same item number.

Supersedes, Superseded By
(SUPSDS, SUPSD BY)

The part supersedes and is not interchangeable with the original part.

Replaces, Replaced By
(REPLS, REPLD BY)

The part replaces and is interchangeable with, or is an alternate to, the original part.

25-29-53

ILLUSTRATED PARTS LIST

01

Page 1001

Jul 10/85

VENDORS

00779 TYCO ELECTRONICS CORP
2800 FULLING MILL ROAD PO BOX 3608
MIDDLETOWN, PENNSYLVANIA 17057
FORMERLY AMP INC

09922 FRAMATOME CONNECTORS FRANCE
50 GRUMBACHER ROAD
YORK, PENNSYLVANIA 17402
FORMERLY BURNDY ENGRG CO V02198; FORMERLY BURNDY CORP
FORMERLY NORWALK, CONNECTICUT

15084 DUPREE INC AEROSPACE KNOB CO DIV
14395 RAMONA PO BOX 1797
CHINO, CALIFORNIA 91708-1797
FORMERLY AEROSPACE KNOB CO DIV OF DUPREE INC
FORMERLY IN SOUTH EL MONTE, CALIFORNIA

15653 FAIRCHILD FASTENERS KAYNAR PRODUCTS DIV
800 S STATE COLLEGE BLVD
FULLERTON, CALIFORNIA 92831-3001
FORMERLY VK6405 MICRODOT AEROSP LTD; FORMERLY KAYNAR TECH
KAYNAR DIV

15805 FURON A E C
3711 SOUTH HUDSON STREET
SEATTLE, WASHINGTON 98118-1919
FORMERLY ASSOC IND V29762, FABRICATORS INC DIV OF
FLUOROCARBON CO AND FLUOROCARBON CO SEATTLE DIV

26014 ELECTROFORMERS INC
11 AUGUSTA DRIVE PO BOX 340
DANBURY, CONNECTICUT 06810-6241
FORMERLY HELI-COIL CORP ELECTROFORMING DIV
FORMERLY MITE CORP GAR ELECTROFORMING DIV
FORMERLY GAR ELECTROFORMING DIV ELECTROFORMERS INC

29372 FAIRCHILD IND INC AEROSP FSTNRS DIV SOUTHBAY OPNS/TRIDAIR
3000 WEST LOMITA BLVD
TORRANCE, CALIFORNIA 90505-5103
FORMERLY CALFAX INC V11907; NEWTON INSERT CO V98004; REXNORD
INC SPECIALTY FASTENER DIV AND DELRON CO V82831; REXNORD
INC TRIDAIR IND

34941 HARPER ENGINEERING COMPANY
200 SOUTH TOBIN STREET
RENTON, WASHINGTON 98055-1307

35344 LEACH CORP RELAY DIV SEE LEACH CORP CONTROL PROD DIV V58657

25-29-53

ILLUSTRATED PARTS LIST
01.1 Page 1002
Nov 01/01

BOEING
 COMPONENT
 MAINTENANCE MANUAL
VENDORS

52828 REPUBLIC FASTENER MFG CORP
 1300 RANCHO CONEJO BLVD
 NEWBURY PARK, CALIFORNIA 91320-1405
 FORMERLY IN SYLMAR, CALIFORNIA

56623 BABCOCK INC
 14930 E ALONDRA BLVD
 LA MIRADA, CALIFORNIA 90638-5752
 FORMERLY IN COSTS MESA, CA & IN ORANGE, CA

58657 LEACH INTERNATIONAL OF NORTH AMERICA
 6900 ORANGETHORPE AVE PO BOX 5032
 BUENA PARK, CALIFORNIA 90622-5032
 FORMERLY LEACH CORP V35344 AND V00614
 FORMERLY LEACH CORP

6E102 METAL FORM INC
 19420 84TH AVE SOUTH EAST VALLEY HWY
 KENT, WASHINGTON 98031

65092 WESTON INSTRUMENTS SEE AMETEK INC U S GAUGE DIV V61349

71087 BOOTS ACFT NUT DIV TOWNSEND CO SEE TEXTRON INC CHERRY
 FASTENER TOWNSEND DIV V11815

71590 CRL COMPONENTS INC
 FORT DODGE, IOWA 50501
 BUSINESS DISCONTINUED

72962 HARVARD INDUSTRIES INC
 3 WERNER WAY SUITE 210
 LEBANON, NEW JERSEY 08833
 FORMERLY AMERACE CORP ESNA DIV
 FORMERLY ELASTIC STOP NUT IN UNION, NJ

75345 KIRKHILL RUBBER CO
 300 EAST CYPRESS STREET
 BREA, CALIFORNIA 92621-4007
 FORMERLY L.A. STANDARD RUBBER CO V84914

78290 STRUTHERS-DUNN INC
 SOUTH WINDSOR, CONNECTICUT 06074
 OBSOLETE - OUT OF BUSINESS

25-29-53

 ILLUSTRATED PARTS LIST
 01.1 Page 1003
 Nov 01/01

VENDORS

80539 SPS TECHNOLOGIES INC AEROSPACE PRODUCTS DIV
2701 SOUTH HARBOR BOULEVARD PO BOX 1259
SANTA ANA, CALIFORNIA 92702-1259
FORMERLY NUTT-SHEL DIV OF SPC WESTERN CO V80539
AND STANDARD PRESSED STEEL WESTERN DIV V17279

81073 GRAYHILL, INCORPORATED
561 HILLGROVE AVENUE PO BOX 10373
LA GRANGE, ILLINOIS 60525-5914

83014 HARTWELL CORPORATION
900 SOUTH RICHFIELD ROAD
PLACENTIA, CALIFORNIA 92670-6732
FORMERLY V0532B IN LOS ANGELES, CALIFORNIA

84914 LOS ANGELES STD RUBBER CO SEE KIRKHILL RUBBER CO V75345

91929 HONEYWELL INC MICRO SWITCH DIV
11 WEST SPRING STREET
FREEPORT, ILLINOIS 61032
FORMERLY MICRO SWITCH A DIV OF HONEYWELL
FORMERLY V74059 AND V40228

92215 FAIRCHILD IND INC FAIRCHILD AEROSPACE FASTENER DIV
3010 W LOMITA BLVD
TORRANCE, CALIFORNIA 90505-5102
FORMERLY VOI-SHAN IN CULVER CITY, CALIF

94222 SOUTHCO INCORPORATED
210 NORTH BRINTON LAKE ROAD
CONCORDVILLE, PENNSYLVANIA 19331
FORMERLY SOUTH CHESTER CORP. SOUTHCO DIVN V24248
FORMERLY IN LESTER, PENNSYLVANIA

95272 SARGENT IND INC STILLMAN SEAL DIV
6020 AVENDIDA ENCINAS PO BOX 2000
CARLSBAD, CALIFORNIA 92008-4407
FORMERLY STILLMAN RUBBER DIV ELECTRADA CORP
FORMERLY STILLMAN SEAL DIV OF SARGENT IND IN CULVER CITY, CA

97393 SHUR-LOK CORPORATION
2541 WHITE ROAD PO BOX 19584
IRVINE, CALIFORNIA 92713
FORMERLY SHUR LOK CORP VB0060
FORMERLY IN SANTA ANA, CALIFORNIA 92714

25-29-53

ILLUSTRATED PARTS LIST
01.1 Page 1004
Nov 01/01

**BOEING**
COMPONENT
MAINTENANCE MANUALVENDORS

98927 ELEC SPEC CORP ELECTRONIC SPECIALITY DIV
14511 NORTHEAST 13TH AVENUE PO BOX 3501
VANCOUVER, WASHINGTON 98668-3501
FORMERLY ELECTRONIC SPECIALTY CO PORTLAND ELECTRONIC DIV
FORMERLY DATRON SYSTEMS INC ELECTRONIC SPECIALITY DIV
FORMERLY IN PORTLAND, OREGON

99699 DEUTSCH RELAYS INC
65 DALY ROAD
EAST NORTHPORT, L.I., NEW YORK 11731-6304
FORMERLY DEUTSCH CO ELECTRONIC COMPONENTS DIV DEUTSCH RELAY

25-29-53ILLUSTRATED PARTS LIST
01.1 Page 1005
Nov 01/01

REFERENCE DESIGNATOR INDEX (SEE SCHEMATIC DIAGRAM)

REFERENCE DESIGNATOR	PART NUMBER	FIG-ITEM
CR1-CR8	YHLZD9	1-160
K1	61GB19-1A320	145
K2	61GB19-1A320	145
K3	JAD9F007	147
K4	JAD9F007	147
N1	522714	137
P1	BACC45FT24B61P	165
P2	BACC45FT16B24P	170
S1	2100-13	100
S3	2100-3	55
S4	2100-3	57
S5	2100-3	55
S6	44MY26366	80
S6	44MY26452	80A
S7	44MY232320	75
S9	2100-1	107
S10	2100-1	107
S11	2100-1	107
S12	2100-1	107
S13	2100-6	110
S14	2100-1	105
S15	2100-3	55
S16	2100-3	55
S18	2100-6	110
S19	2100-1	105
S20	2100-3	56
S23	44YY23734	90A
S24	BA08121655	85
S25	2100-3	55
S27	2400-3	45
S28	2400-3	45
S30	2100-3	55
S31	44MY24771	70

25-29-53

BOEING
 COMPONENT
 MAINTENANCE MANUAL

PART NUMBER	AIRLINE PART NO.	FIG.	ITEM	TTL REQ
AML76C10T01P		1	135	1
AML78CB001		1	94	2
		1	95	9
		1	96	1
		1	97	1
		1	98	7
AML78FB001		1	60	2
AMMC6		1	150	2
AMY0310T5		1	180	1
AN96OPD8L		1	30	6
BACC10DK		1	10	1
BACC45FT16B24P		1	170	1
BACC45FT24B61P		1	165	1
BACC47DE1		1	155B	1
BACC47DE7		1	155	8
		1	155A	7
BACC49A1		1	150	2
BACN10JC08		1	5	1
BACP20BA1		1	15	1
BACR11AM2		1	200	2
		1	202	2
BACR12AG2C		1	355	2
BACR13CF2A		1	145	2
BACR13CJ2		1	147	2
BACR15BA3AD		1	195	4
		1	197	4
BACS16X1		1	140	2
BACS16X3		1	146	2
BACS21AP80R		1	350	2
BACS21AP80RP		1	350A	2
BACT44B0310U		1	180	1

25-29-53

 ILLUSTRATED PARTS LIST
 01.1 Page 1007
 Nov 01/01

PART NUMBER	AIRLINE PART NO.	FIG.	ITEM	TTL REQ
BAC27TPPS0131		1	310	1
BAC27TPPS4100		1	312	1
BA08121655		1	85	1
BRH10A08		1	5	1
BR246S0112		1	145	2
BR64S104		1	145	2
E210-1631		1	145	2
E215-1050		1	145	2
FAB278		1	150	2
FCA210-70		1	145	2
H10-08BAC		1	5	1
H1002S1-5W1		1	330	1
H28-1		1	150	2
JAD9F007		1	147	2
JD4A017		1	145	2
KN0832JMXSZ		1	325C	11
MS35333-38		1	35	6
MS51830A104		1	325D	11
NAS1394-08		1	325	11
NAS1801-08-4		1	25	6
NS202101-82		1	5	1
N2088		1	15	1
RD409-101		1	65	5
RMLH9075-82W		1	5	1
SL6156-08		1	320	1
SZ7105		1	15	1
S417T600-3		1	137	1
TNC2C0164		1	325B	11
T6S832J		1	5	1
UP103		1	150	2
VN303A82		1	5	1
YHLZD9		1	160	8
1185-2CN0164		1	325A	11
2-295		1	200	2
		1	202	2

25-29-53

 ILLUSTRATED PARTS LIST
 01.1 Page 1008
 Nov 01/01

BOEING
 COMPONENT
 MAINTENANCE MANUAL

PART NUMBER	AIRLINE PART NO.	FIG.	ITEM	TTL REQ
2100-1		1	105	2
		1	107	4
2100-100		1	115	6
		1	116	1
		1	117	1
2100-101		1	120	1
2100-103		1	125	2
2100-13		1	100	1
2100-143		1	130	2
2100-151		1	119	4
2100-159		1	125A	2
2100-3		1	55	6
		1	56	1
		1	57	1
2100-6		1	110	2
2400-102		1	40B	2
2400-3		1	45	2
417T6005-2		1	340	1
417T6005-4		1	345	1
417T6007-11		1	370	1
417T6007-4		1	330	1
417T6007-9		1	315	1
417T6008-42		1	1	RF
417T6008-43		1	1A	RF
417T6008-44		1	1B	RF
417T6008-45		1	1C	RF
417T6008-46		1	1D	RF
417T6008-47		1	1E	RF
417T6008-48		1	1F	RF
417T6008-49		1	1G	RF
417T6008-51		1	1H	RF
417T6008-52		1	1J	RF
417T6009-239		1	20J	1
417T6009-53		1	20	1
417T6009-55		1	20A	1
417T6009-56		1	20D	1
417T6009-58		1	20B	1
417T6009-59		1	20C	1
417T6009-61		1	20E	1
417T6009-81		1	20F	1
417T6009-82		1	20G	1
417T6009-88		1	20H	1
417T6011-17		1	177	1
417T6011-21		1	175	1
417T6011-38		1	177A	1

25-29-53

 ILLUSTRATED PARTS LIST
 01.1 Page 1009
 Nov 01/01

PART NUMBER	AIRLINE PART NO.	FIG.	ITEM	TTL REQ
417T6011-46		1	175A	1
417T6011-5		1	178	1
417T6012-11		1	245	1
417T6012-13		1	240	1
417T6012-19		1	255	1
417T6012-2		1	235	2
417T6012-21		1	260	1
417T6012-23		1	275	1
417T6012-25		1	280	1
417T6012-27		1	290	1
417T6012-29		1	295	1
417T6012-3		1	265	9
		1	266	1
		1	267	1
		1	268	7
		1	290A	1
		1	295A	1
417T6012-31		1	285	1
417T6012-33		1	300	1
417T6012-4		1	225	1
417T6012-5		1	270	1
417T6012-6		1	230	1
417T6012-65		1	305	1
417T6012-7		1	250	1
417T6012-71		1	301	1
417T6012-73		1	302	1
417T6012-75		1	303	1
417T6012-77		1	304	1
417T6014-14		1	322	1
417T6014-3		1	360	1
417T6014-6		1	365	1
417T6017-1		1	148	2
		1	185	2
417T6017-2		1	190	2
		1	192	2
417T6017-3		1	205	2
		1	207	2
417T6019-1		1	17	1
		1	50	1
44MY232320		1	75	1
44MY24771		1	70	1
44MY26366		1	80	1
44MY26452		1	80A	1
44YY23734		1	90A	1

25-29-53

 ILLUSTRATED PARTS LIST
 01.1 Page 1010
 Nov 01/01

BOEING
 COMPONENT
 MAINTENANCE MANUAL

PART NUMBER	AIRLINE PART NO.	FIG.	ITEM	TTL REQ
4841		1	15	1
522714		1	137	1
60729-1		1	172	1
61GB19-1A320		1	145	2
61048-1		1	172A	1
		1	173	1
82-99-341-08		1	350A	2
82-99-342-15		1	200	2
		1	202	2
96-82		1	5	1

25-29-53

ILLUSTRATED PARTS LIST

01.1 Page 1011

Nov 01/01

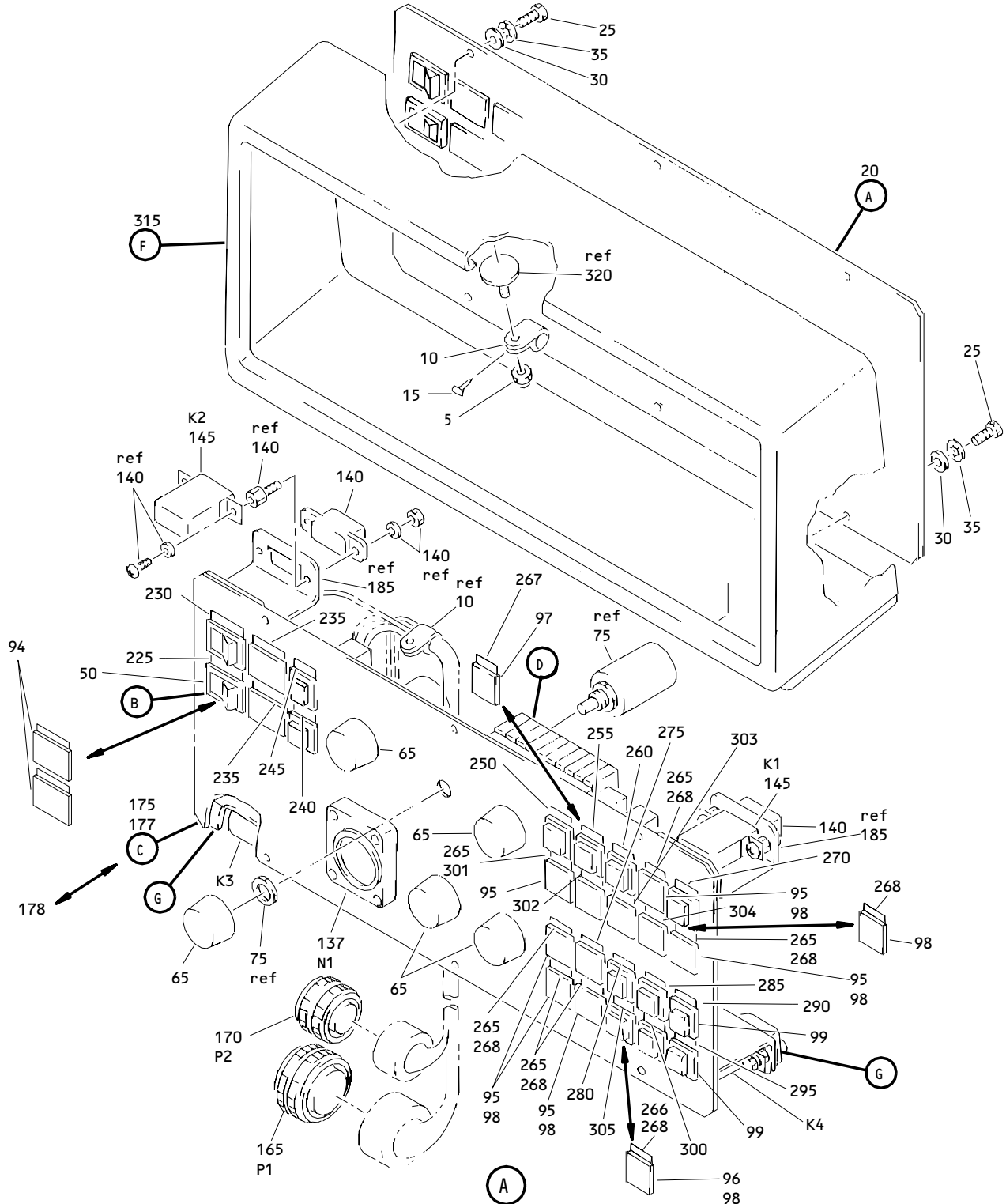

Forward Attendants Panel Assembly
 Figure 1 (Sheet 1)

25-29-53

ILLUSTRATED PARTS LIST
 01.1 Page 1012
 Nov 01/01

BOEING
COMPONENT
MAINTENANCE MANUAL

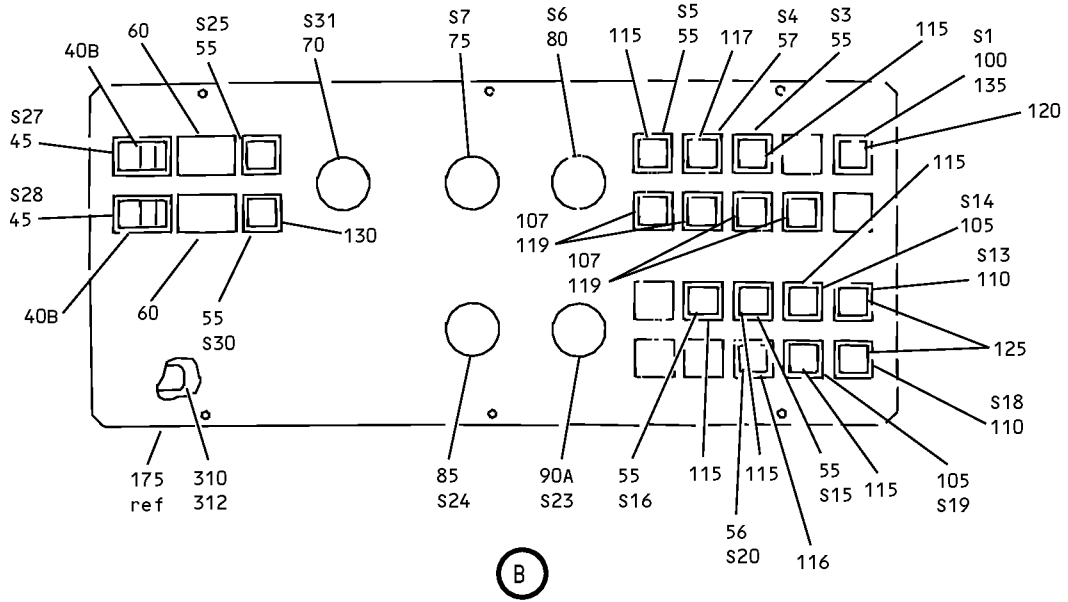

(B)

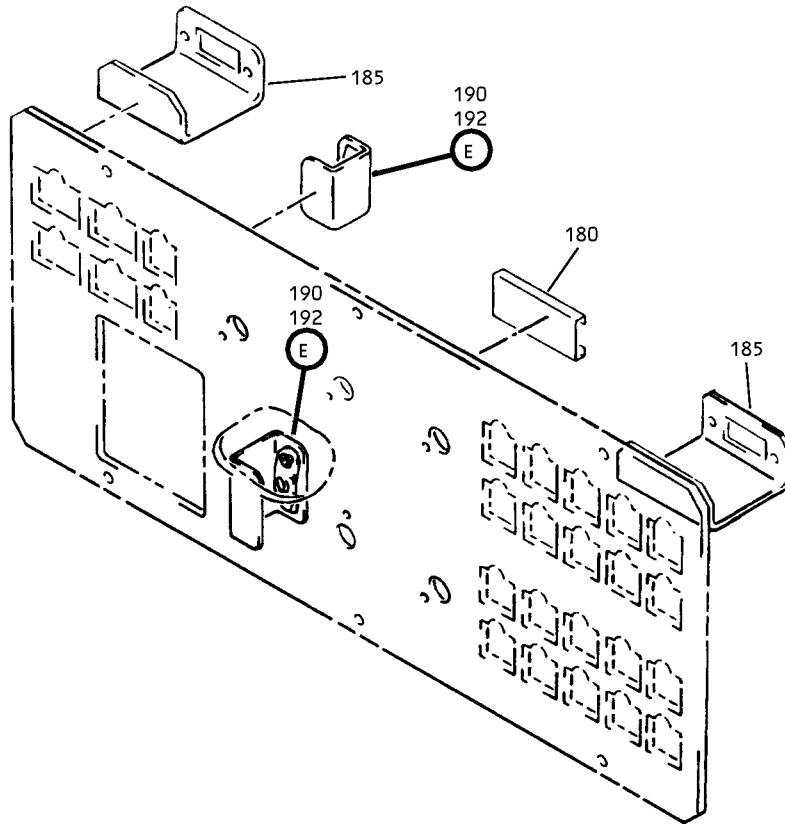

(C)

Forward Attendants Panel Assembly
 Figure 1 (Sheet 2)

25-29-53

ILLUSTRATED PARTS LIST
 01.1 Page 1013
 Nov 01/01

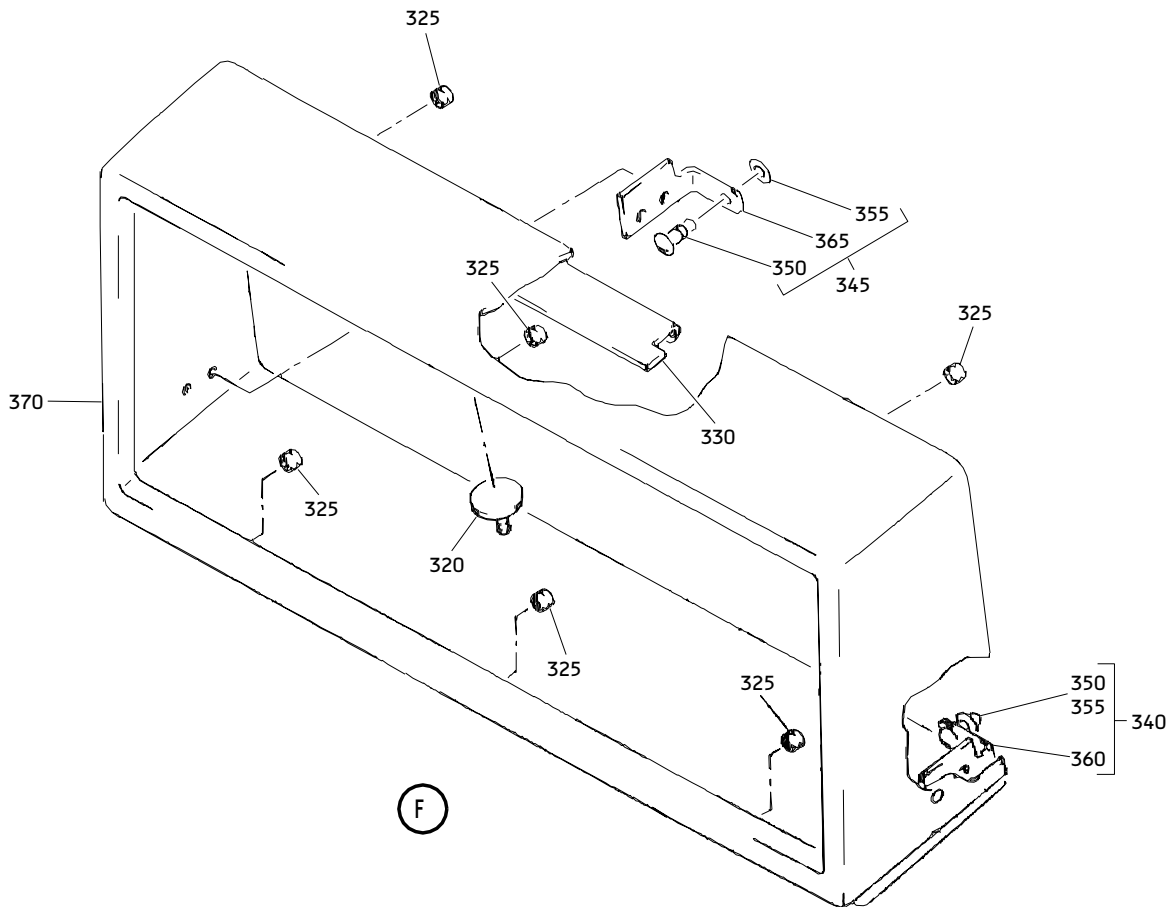
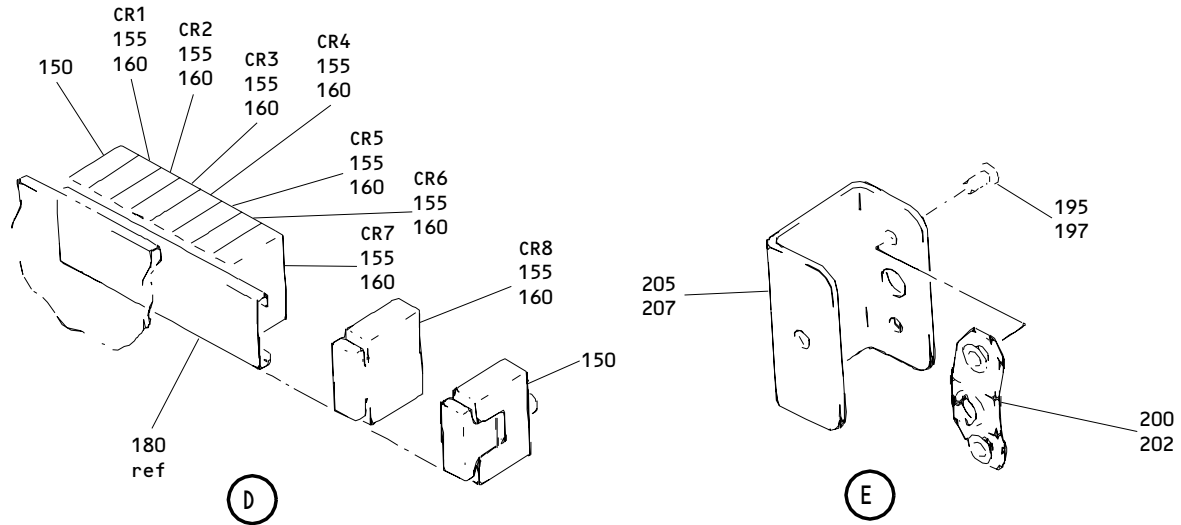

Forward Attendants Panel Assembly
 Figure 1 (Sheet 3)

25-29-53

ILLUSTRATED PARTS LIST
 01.1 Page 1014
 Nov 01/01

BOEING
 COMPONENT
 MAINTENANCE MANUAL

FIG. & ITEM	PART NO.	AIRLINE PART NUMBER	NOMENCLATURE 1234567	EFF CODE	QTY PER ASSY
01-					
-1	417T6008-42		PANEL ASSY-FWD ATTENDANTS	A	RF
-1A	417T6008-43		PANEL ASSY-FWD ATTENDANTS	B	RF
-1B	417T6008-44		PANEL ASSY-FWD ATTENDANTS	C	RF
-1C	417T6008-45		PANEL ASSY-FWD ATTENDANTS	D	RF
-1D	417T6008-46		PANEL ASSY-FWD ATTENDANTS	E	RF
-1E	417T6008-47		PANEL ASSY-FWD ATTENDANTS	F	RF
-1F	417T6008-48		PANEL ASSY-FWD ATTENDANTS	G	RF
-1G	417T6008-49		PANEL ASSY-FWD ATTENDANTS	H	RF
-1H	417T6008-51		PANEL ASSY-FWD ATTENDANTS	J	RF
-1J	417T6008-52		PANEL ASSY-FWD ATTENDANTS	K	RF
5	H10-08BAC		.NUT- (V15653) (SPEC BACN10JC08) (OPT NS202101-82 (V80539)) (OPT RMLH9075-82W (V72962)) (OPT T6S832J (V71087)) (OPT VN303A82 (V92215)) (OPT 96-82 (V80539)) (OPT BRH10A08 (V52828))		1
10	BACC10DK		.CLAMP- (SIZE DETERMINE ON INST)		1
15	N2088		.PLUG- (V75345) (SPEC BACP20BA1) (OPT SZ7105 (V95272)) (OPT 4841 (V84914))		1
-17	417T6019-1		.BEZEL-EMER LT TEST SW RAISED	B-K	1
20	417T6009-53		.WIRING ASSY-FACEPLATE	A	1
-20A	417T6009-55		.WIRING ASSY-FACEPLATE	B	1
-20B	417T6009-58		.WIRING ASSY-FACEPLATE	C	1
-20C	417T6009-59		.WIRING ASSY-FACEPLATE	D	1
-20D	417T6009-56		.WIRING ASSY-FACEPLATE	F	1
-20E	417T6009-61		.WIRING ASSY-FACEPLATE	E	1
-20F	417T6009-81		.WIRING ASSY-FACEPLATE	G	1
-20G	417T6009-82		.WIRING ASSY-FACEPLATE	H	1
-20H	417T6009-88		.WIRING ASSY-FACEPLATE	J	1

25-29-53

ILLUSTRATED PARTS LIST

01.1

Page 1015

Nov 01/01

FIG. & ITEM	PART NO.	AIRLINE PART NUMBER	NOMENCLATURE 1234567	EFF CODE	QTY PER ASSY
01- -20J	417T6009-239		.WIRING ASSY-FACEPLATE ATTACHING PARTS	K	1
25	NAS1801-08-4		.SCREW		6
30	AN960PD8L		.WASHER		6
35	MS35333-38		.WASHER		6
			-----*-----		
40	2400-100		DELETED		
-40A	2400-200		DELETED		
40B	2400-102		..LENS-WHITE (V91929)		2
45	2400-3		..SWITCH-2 POLE 2 POSITION (ON MOM) ONE LAMP ROCKER (V91929) (S27, S28)		2
50	417T6019-1		..BEZEL-EMER LT TEST SW RAISED	A	1
55	2100-3		..SWITCH-TWO POLE ALT (V91929) (S3, S5, S15, S16, S25 S30)		6
56	2100-3		..SWITCH-TWO POLE ALT (V91929) (S20)	A	1
57	2100-3		..SWITCH-TWO POLE ALT (V91929) (S4)	A-C, E , G	1
60	AML78FB001		..PLUG-RECTANGULAR (V91929)		2
65	RD409-101		..KNOB- (V15084)		5
70	44MY24771		..SWITCH-ROTARY (V81073) (S31)		1
75	44MY232320		..SWITCH-THREE DECKS ROTARY (V81073) (S7)		1
80	44MY26366		..SWITCH-ROTARY (V81073) (S6)	A-F, H	1
-80A	44MY26452		..SWITCH-ROTARY (V81073) (S6)	G, J, K	1

25-29-53

 ILLUSTRATED PARTS LIST
 01.1 Page 1016
 Nov 01/01

BOEING
 COMPONENT
 MAINTENANCE MANUAL

FIG. & ITEM	PART NO.	AIRLINE PART NUMBER	NOMENCLATURE 1234567	EFF CODE	QTY PER ASSY
01-85	BA08121655		..SWITCH-10K POT (V71590) (S24)		1
90	44Y23734		DELETED		
90A	44YY23734		..SWITCH-ROTARY (V81073) (S23)		1
94	AML78CB001		..PLUG-SQUARE (V91929)	K	2
95	AML78CB001		..PLUG-SQUARE (V91929)	A-F, H-K	9
96	AML78CB001		..PLUG-SQUARE (V91929)	B-F, H-K	1
97	AML78CB001		..PLUG-SQUARE (V91929)	D,F, H-K	1
98	AML78CB001		..PLUG-SQUARE (V91929)	G	7
100	2100-13		..SWITCH-FOUR POLE ALT (V91929) (S1)	A-F, H-K	1
105	2100-1		..SWITCH-TWO POLE MOM (V91929) (S14, S19)		2
107	2100-1		..SWITCH-TWO POLE MOM (V91929) (S9, S10, S11, S12)	G	4
110	2100-6		..SWITCH-TWO POLE MOM (V91929) (S13, S18)	A-J	2
115	2100-100		..LENS-NO INSERT WHITE (V91929)		6

25-29-53

 ILLUSTRATED PARTS LIST
 01.1 Page 1017
 Nov 01/01

FIG. & ITEM	PART NO.	AIRLINE PART NUMBER	NOMENCLATURE 1234567	EFF CODE	QTY PER ASSY
01-116	2100-100		..LENS-NO INSERT WHITE (V91929)	A	1
117	2100-100		..LENS-WHITE (V91929)	A-C, E, G	1
118	2100-100		DELETED		
119	2100-151		..LENS-WHITE (ARMED) (V91929)	G	4
120	2100-101		..LENS-RED INSERT WHITE (V91929)	A-F, H-K	1
125	2100-103		..LENS-ARROW WHITE (V91929) (OPT ITEM 125A)		2
-125A	2100-159		..LENS-ARROW WHITE (V91929) (OPT ITEM 125)		2
130	2100-143		..LENS-AMBER INSERT POWER ON LEGEND WHITE (V91929)		2
135	AML76C10T01P		..GUARD-SWITCH (V91929)	A-F, H-K	1
137	522714		..INDICATOR-POTABLE WATER QTY GAGE (V65092) (SPEC S417T600-3) (N1)	F	1
140	BACS16X1		..SOCKET		2
145	61GB19-1A320		..RELAY- (V98927) (SPEC BACR13CF2A) (OPT JD4A017 (V35344)) (OPT BR64S104 (V56623)) (OPT BR246S0112 (V56623)) (OPT FCA210-70 (V78290)) (OPT E215-1050 (V99699)) (OPT E210-1631 (V99699)) (K1, K2)		2

25-29-53

 ILLUSTRATED PARTS LIST
 01.1 Page 1018
 Nov 01/01

BOEING
 COMPONENT
 MAINTENANCE MANUAL

FIG. & ITEM	PART NO.	AIRLINE PART NUMBER	NOMENCLATURE 1234567	EFF CODE	QTY PER ASSY
01-					
146	BACS16X3		..SOCKET	C,E	2
147	JAD9F007		..RELAY- (V58657) (SPEC BACR13CJ2) (K3, K4)	C,E	2
148	417T6017-1		..BRACKET-RELAY	C,E,G	2
150	AMMC6		..CLAMP ASSY- (V09922) (SPEC BACC49A1) (OPT FAB278 (V15805)) (OPT H28-1 (V34941)) (OPT UP103 (V6E102))		2
155	BACC47DE7		..CONTACT	A-C, F-H	AR
-155A	BACC47DE7		..CONTACT	D,E,J K	AR
-155B	BACC47DE1		..CONTACT	D,E,J K	AR
160	YHLZD9		..DIODE-MODULE (V09922) (CR1-CR8)		8
165	BACC45FT24B61P		..CONNECTOR- (EQUIP. NO. D1646) (P1)		1
170	BACC45FT16B24P		..CONNECTOR- (EQUIP. NO. D837) (P2)		1
-172	60729-1		..TERMINAL-POKE ON (V00779) (OPT ITEM 172A)	A	AR

25-29-53

 ILLUSTRATED PARTS LIST
 01.1 Page 1019
 Nov 01/01

FIG. & ITEM	PART NO.	AIRLINE PART NUMBER	NOMENCLATURE 1234567	EFF CODE	QTY PER ASSY
01- -172A	61048-1		..TERMINAL-POKE ON (V00779) (OPT ITEM 172)	A	AR
-173	61048-1		..TERMINAL-POKE ON (V00779)	C,D, H-K	AR
175	417T6011-21		..FACEPLATE ASSY	A-C,H	1
-175A	417T6011-46		..FACEPLATE ASSY	E	1
177	417T6011-17		..FACEPLATE ASSY	D,J,K	1
-177A	417T6011-38		..FACEPLATE ASSY	F	1
178	417T6011-5		..FACEPLATE ASSY	G	1
180	AMY0310T5		...TRACK- (V09922) (SPEC BACT44B0310U)		1
185	417T6017-1		...BRACKET-MTG		2
190	417T6017-2		...BRACKET ASSY-MTG	A-C,E H	2
192	417T6017-2		...BRACKET ASSY-MTG	D,F,J K	2
195	BACR15BA3AD	RIVET- (SIZE DETERMINE ON INST)	A-C,E H	2
197	BACR15BA3AD	RIVET- (SIZE DETERMINE ON INST)	D,F,J K	2
200	82-99-342-15	RECEPTACLE- (V94222) (SPEC BACR11AM2) (OPT 2-295 (V94222))	A-C,E H	1
202	82-99-342-15	RECEPTACLE- (V94222) (SPEC BACR11AM2) (OPT 2-295 (V94222))	D,F,J K	1
205	417T6017-3	BRACKET	A-C,E H	1
207	417T6017-3	BRACKET	D,F,J K	1
210	417T6011-24		DELETED		
-210A	417T6011-49		DELETED		
212	417T6011-20		DELETED		
-212A	417T6011-41		DELETED		
213	417T6011-8		DELETED		
215	417T6011-23		DELETED		

25-29-53

 ILLUSTRATED PARTS LIST
 01.1 Page 1020
 Nov 01/01

BOEING
 COMPONENT
 MAINTENANCE MANUAL

FIG. & ITEM	PART NO.	AIRLINE PART NUMBER	NOMENCLATURE 1234567	EFF CODE	QTY PER ASSY
01-					
-215A	417T6011-48		DELETED		
217	417T6011-19		DELETED		
-217A	417T6011-40		DELETED		
218	417T6011-7		DELETED		
220	417T6011-22		DELETED		
-220A	417T6011-47		DELETED		
222	417T6011-18		DELETED		
-222A	417T6011-39		DELETED		
223	417T6011-6		DELETED		
225	417T6012-4		..DECAL-EMER LTS SLIP IN		1
230	417T6012-6		..DECAL-GND SRVC BUS SLIP IN		1
235	417T6012-2		..DECAL-NO LEGEND SLIP IN		2
240	417T6012-13		..DECAL-ENTRY R SLIP IN		1
245	417T6012-11		..DECAL-ENTRY L SLIP IN		1
250	417T6012-7		..DECAL-ATTND L SLIP IN		1
255	417T6012-19		..DECAL-SLIP IN (ATTND C)	A-C,E	1
260	417T6012-21		..DECAL-LEFT ENTRY CLG SLIP IN		1
265	417T6012-3		..DECAL-NO LEGEND SLIP IN	A-F, H-K	9
266	417T6012-3		..DECAL-NO LEGEND SLIP IN	B-F, H-K	1
267	417T6012-3		..DECAL-NO LEGEND SLIP IN	D,F, H-K	1
268	417T6012-3		..DECAL-NO LEGEND SLIP IN	G	7
270	417T6012-5		..DECAL-EMER LTG SLIP IN	A-F, H-K	1
275	417T6012-23		..DECAL-PASS ENT SYST PWR SLIP IN		1

25-29-53

 ILLUSTRATED PARTS LIST
 01.1 Page 1021
 Nov 01/01

FIG. & ITEM	PART NO.	AIRLINE PART NUMBER	NOMENCLATURE 1234567	EFF CODE	QTY PER ASSY
01-280	417T6012-25		..DECAL-PASS SERV SYST PWR SLIP IN		1
285	417T6012-31		..DECAL-FWD MSTR CALL RESET SLIP IN		1
290	417T6012-27		..DECAL-MAIN DOOR UP SLIP IN	A-J	1
-290A	417T6012-3		..DECAL-NO LEGEND SLIP IN	K	1
295	417T6012-29		..DECAL-MAIN DOOR DOWN SLIP IN	A-J	1
-295A	417T6012-3		..DECAL-NO LEGEND SLIP IN	K	1
300	417T6012-33		..DECAL-AFT MSTR CALL SLIP IN		1
301	417T6012-71		..DECAL-DOOR 1 LEFT SLIP IN	G	1
302	417T6012-73		..DECAL-DOOR 1 RIGHT SLIP IN	G	1
303	417T6012-75		..DECAL-DOOR 2 LEFT SLIP IN	G	1
304	417T6012-77		..DECAL-DOOR 2 RIGHT SLIP IN	G	1
305	417T6012-65		..DECAL-CHIME SHUTOFF SLIP IN	A	1
310	BAC27TPPS0131		..MARKER-ALUMINUM FOIL (M1077)	A-C, E, H	1
312	BAC27TPPS4100		..MARKER-ALUMINUM FOIL (M882)	D, F, J, K	1
315	417T6007-9		.SHROUD ASSY		1
320	SL6156-08		..STUD- (V97393)		1

25-29-53

 ILLUSTRATED PARTS LIST
 01.1 Page 1022
 Nov 01/01

BOEING
 COMPONENT
 MAINTENANCE MANUAL

FIG. & ITEM	PART NO.	AIRLINE PART NUMBER	NOMENCLATURE 1234567	EFF CODE	QTY PER ASSY
01-					
R 322	417T6014-14		..STIFFENER		1
R 325	NAS1394-08		..INSERT- (OPT ITEMS 325A, 325B, 325C, 325D)		11
R -325A	1185-2CN0164		..INSERT- (V26014) (OPT ITEMS 325, 325B, 325C, 325D)		11
R -325B	TNC2C0164		..INSERT- (V29372) (OPT ITEMS 325, 325A, 325C, 325D)		11
R -325C	KN0832JMXSZ		..INSERT- (V29372) (OPT ITEMS 325, 325A, 325B, 325D)		11
R -325D	MS51830A104		..INSERT- (OPT ITEMS 325, 325A, 325B, 325C)		11
	330	417T6007-4	..HINGE- (ALT FROM H1002S1-5W1 (V83014))		1
	-335	60729-1	DELETED		
	-335A	61048-1	DELETED		
	340	417T6005-2	..BRACKET ASSY-MTG		1
	345	417T6005-4	..BRACKET ASSY-MTG		1
	350	BACS21AP80R	...STUD- (OPT ITEM 350A)		1
R -350A	82-99-341-08		...STUD- (V94222) (SPEC BACS21AP80RP) (OPT ITEM 350)		1
	355	BACR12AG2C	...RING- (V94222) (SPEC BACR12AG2C)		1
	360	417T6014-3	...BRACKET- (USED ON ITEM 340)		1
	365	417T6014-6	...BRACKET- (USED ON ITEM 345)		1
R 370	417T6007-11		..SHROUD BOEING LETTER HISTORY		1

- Item Not Illustrated

25-29-53

 ILLUSTRATED PARTS LIST
 01.1 Page 1023
 Nov 01/01